



Z-Drive

The Zacuto Z-Drive is a unique, universal direct drive follow focus, designed with single operator shoulder mounted rigs in mind. Because it has a universal joint and no internal gears it can't develop play. It attaches to a single 15mm diameter rod and curves away from the operator at a 60 degree angle creating space and distance from the lens for comfortable use when the camera is on your shoulder.

The Z-Drive can operate in four modes and is extremely adjustable for all size lenses. It can operate on the camera assistant or operators side of the rig positioned forward toward the lens or backward towards the tripod/dolly etc.. This makes for easy operation with a standard follow focus whip used on a tripod.



Check out our tutorial videos at zacuto.com

Parts & Features

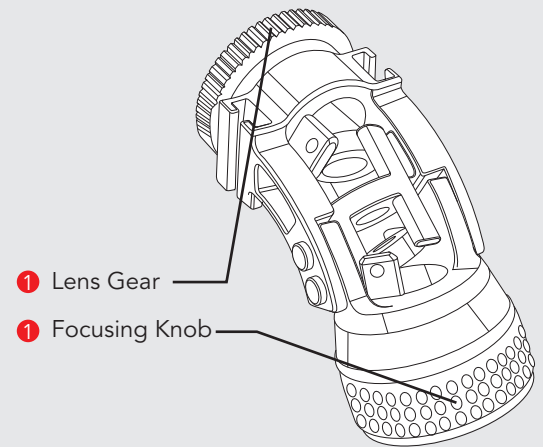
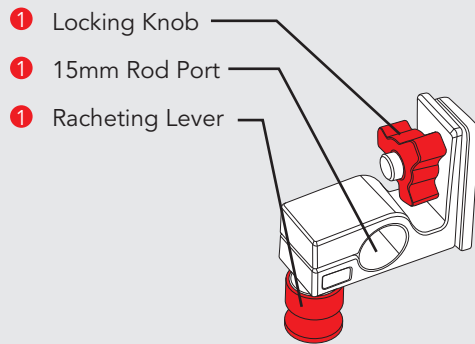

Mounting Z-Drive

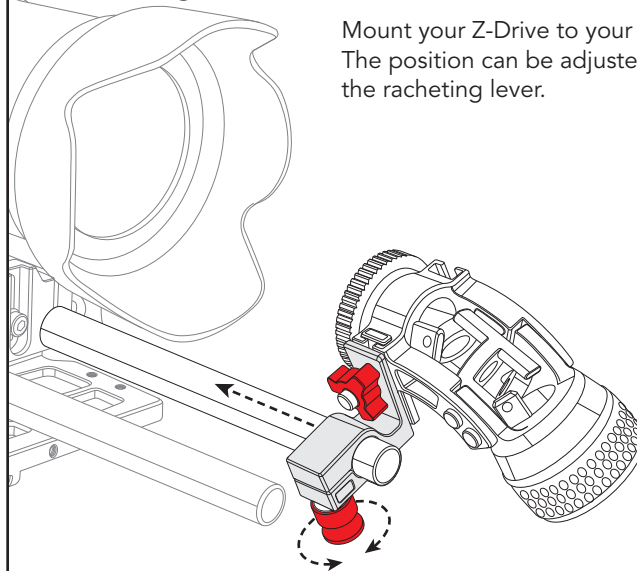

Mount your Z-Drive to your rig by using the 15mm rod port. The position can be adjusted and tightened in place by using the ratcheting lever.

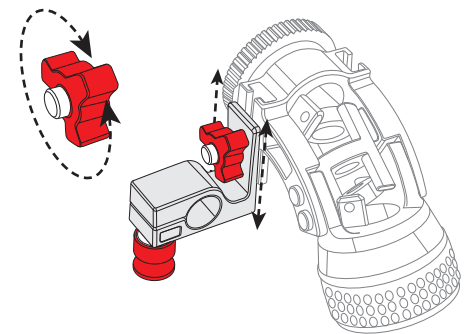

The Z-Drive's rod port can be moved to either side of the Z-Drive for user preference.

Operating Z-Drive

Align the Z-Drive's lens gear to your lens focusing gear. Once aligned operate the Z-Drive by rotating the focusing ring.

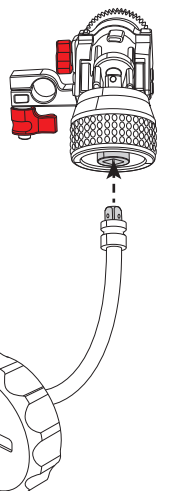
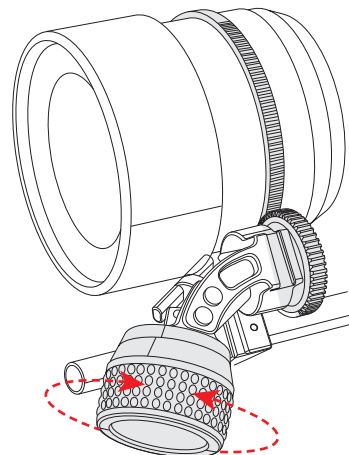
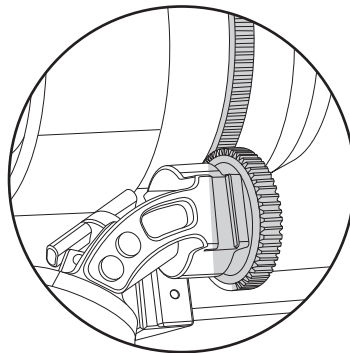

Compatible with optional Z-Whips.